

- ITEM: Dielectric Patch Antenna Element for GPS L1 Band
- Part Number:ANPS1575C2ZDS

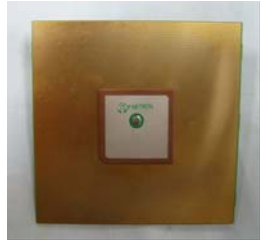

■ Electric Specification

ITEM	SPECIFICATION	UNIT	CONDITIONS
Outline Dimension	25x25x2	mm	
Center Frequency	1575	MHz	with 70mm <sup>2</sup> GND plane
Gain@Zenith	+3.5	dBic typ.	
Band Width	6	MHz typ	@ 10dB Return Loss
Axial Ratio	3.0	dB max.	@ Center Frequency
Impedance	50	Ω	
Polarization	RHCP		
Temperature Coefficient	20	ppm/°C	-40°C to +85°C
※ Measured on 70 square ground plane			

■ Dimension

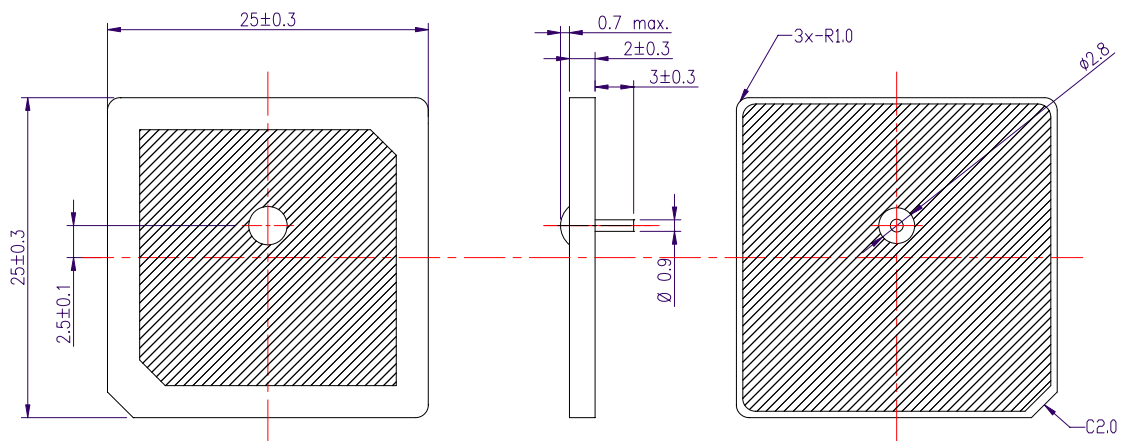

Unit:mm

## ■ Typical Characteristics

### -SmithChart & Return Loss

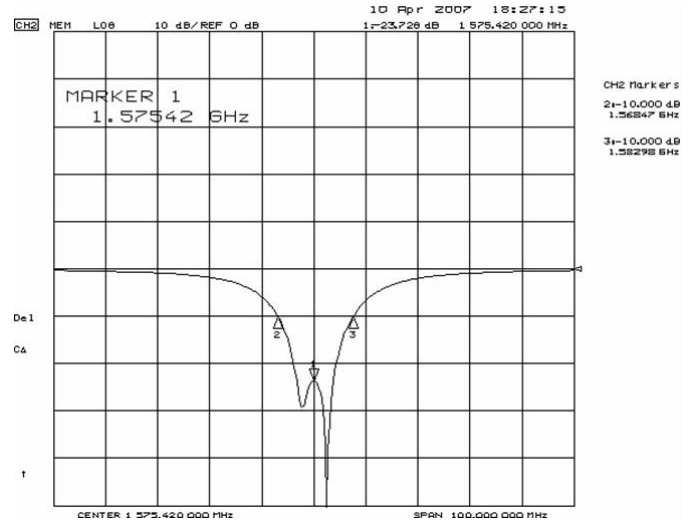
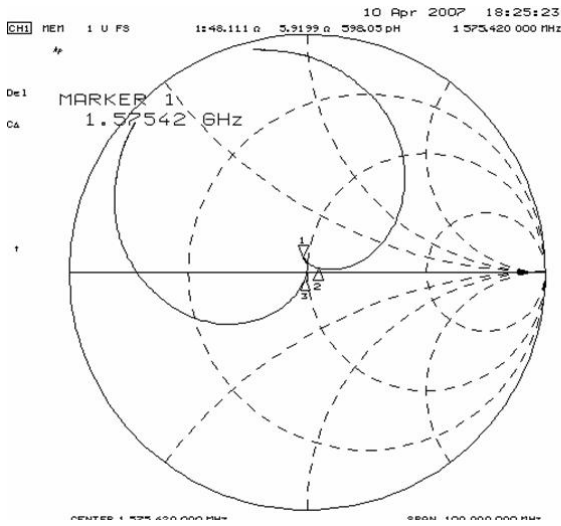

### -Radiation Pattern

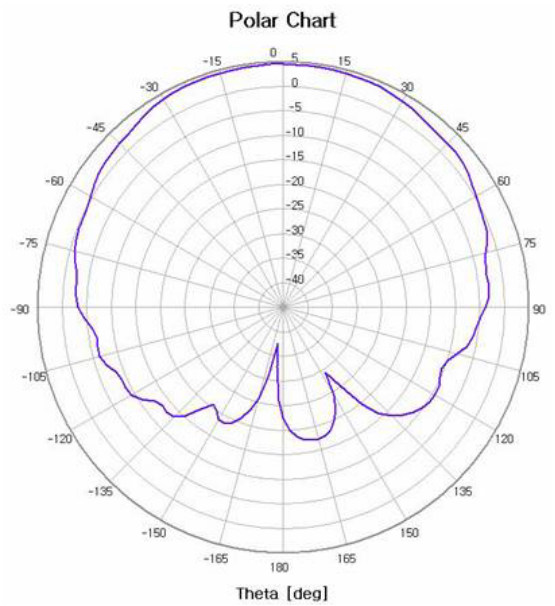
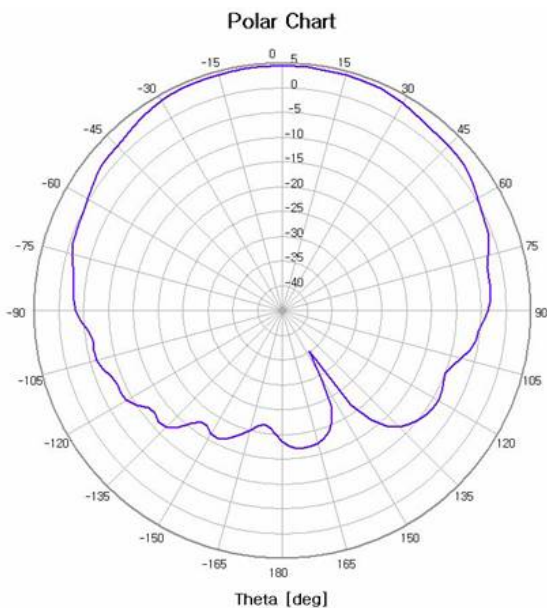
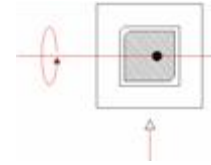
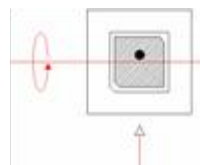

■ Measurement condition

SmithChart and Return Loss(VSWR) measurement

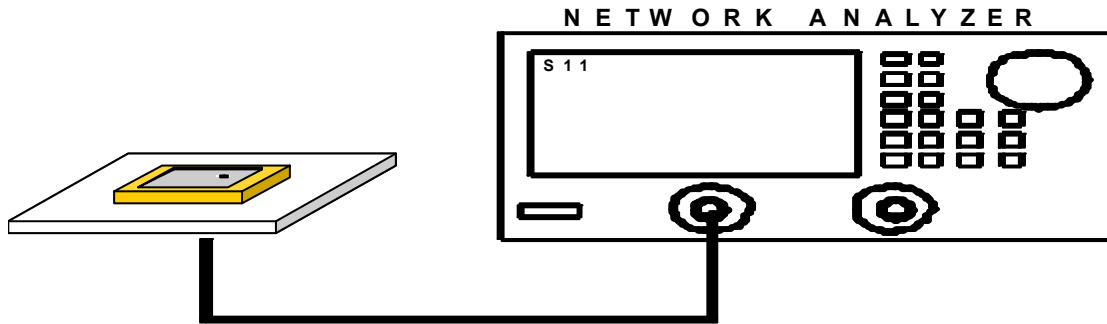

Gain measurement

